

# Aric Stainless Products



SHS-12



HS-1410

## STAINLESS STEEL HAND SINKS

### FEATURES:

HS-1410 and HS-1410-SS: Sink bowl is 10"x14"x5"

SHS12 and SHS12-SS : Sink bowl is 9"x9"x5"

All sink bowls have large liberal radii with a minimum dimension of 2" and rectangular in design for increased capacity.

Keyhole wall mount bracket

Stainless steel basket drain 1-1/2" IPS

### CONSTRUCTION:

All TIG welded.

Welded areas blended to match adjacent surfaces and to a satin finish.

Die formed Countertop Edge with a No-Drip offset.

One sheet of stainless steel - No Seams.

### MATERIAL:

Heavy gauge type 202 series stainless steel.

Wall mounting bracket is 202 series and of offset design.

All fittings are brass / chrome plated unless otherwise indicated.

### MECHANICAL:

Faucet supply is 1/2" IPS male thread hot and cold.

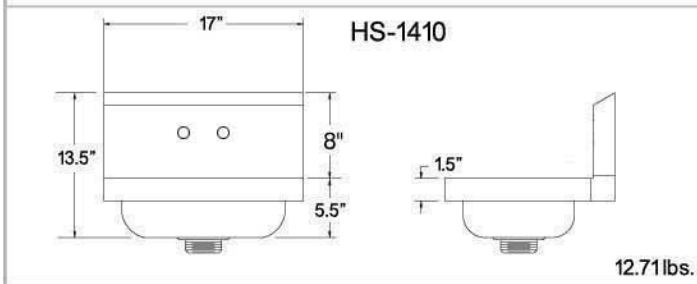
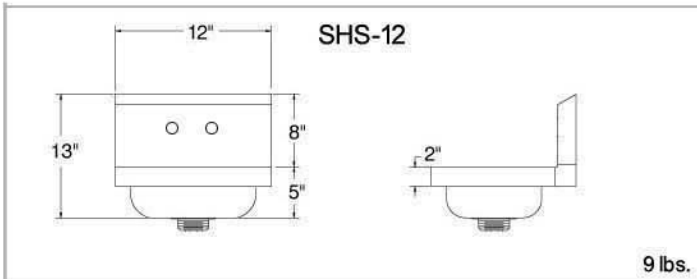

SHS-12-SS



HS-1410-SS

